

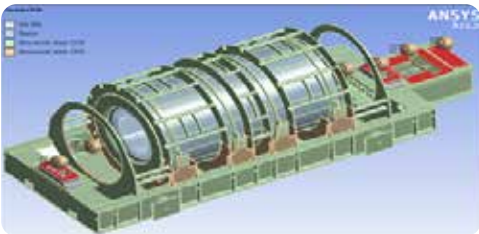

*We exist to solve complex multi-disciplinary problems, leveraging advanced technologies, that increase the resiliency, performance, and longevity of high value assets.*

## OVERVIEW

- **Engineering Consulting Firm**
  - Founded in 1983
  - Employee-owned corporation
  - Experts in prevention and control of structural and mechanical failures
  - Strong participation in industry codes and standards activities
  - Strong involvement with and support of EPRI (BWRVIP, MRP, WRTC, etc.)
- **Senior Technical Staff with Extensive Industry Experience**
  - Highly involved in regulatory issues and interaction with U.S. NRC
- **Full time staff of approximately ~300; large percentage have advanced degrees and Professional Engineering licenses**
- **Quality Assurance**
  - Compliant with: 10 CFR 50, Appendix B; 10 CFR 21; and ANSI/ASME NQA-1-1989/1994
  - ISO 17025 certified (NDE)



## ADVANCED STRUCTURAL ANALYSIS

- **Mass Concrete**
  - Heat of Hydration
  - Shrinkage
  - Cracking
- **Non-Linear Concrete Performance**
  - Concrete Aging and Degradation Modeling
  - ASR, AAR
  - Shrinkage
  - Prestress Losses
- **Fragility - Structures, Systems, Components**
- **Pressure Vessels**
- **Rotating and Reciprocating Equipment Supports and Foundations**
- **Fluid-Structure Interaction (FSI)**
- **Liquid Storage Tanks - Extreme Events**



✉ info@structint.com

🌐 www.structint.com

☎ 1-877-4SI-POWER  
1-877-474-7693

📍 5215 Hellyer Avenue Suite 210  
San Jose, CA 95138

## SEISMIC ANALYSIS

- Seismic Probabilistic Risk Assessment (SPRA)
- Time History Analysis
- Non-Linear Concrete Performance
- Seismic Vulnerability Assessment
- Retrofit Efficacy Evaluation
- Soils-Structure Interaction (SSI)
- Soil fragility
- In-Structure-Response Spectra (ISRS)
- Equipment Analytical Qualifications

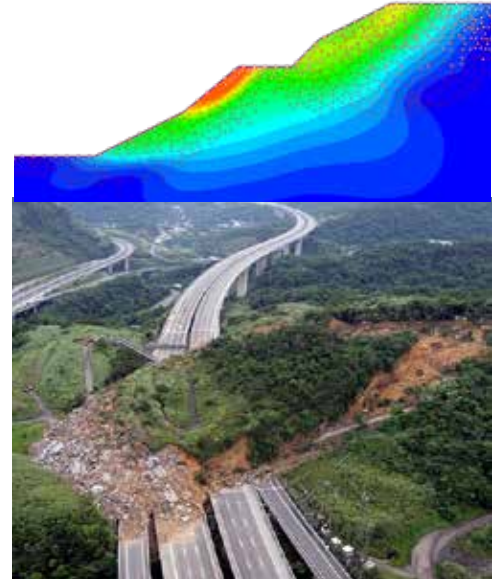

## SHOCK, BLAST AND IMPACT ENGINEERING

- Blast
  - Blast Wave Propagation
  - Anti-Terrorism Force Protection
  - Progressive Collapse Evaluations
  - Deflagration Events
  - Confined Detonations
- Shock
  - Equipment Fragility
  - Equipment Isolation Systems
- Impact
  - Aircraft Impacts
  - Vehicular Impacts
  - Tornado Borne Missiles
  - Load Drops

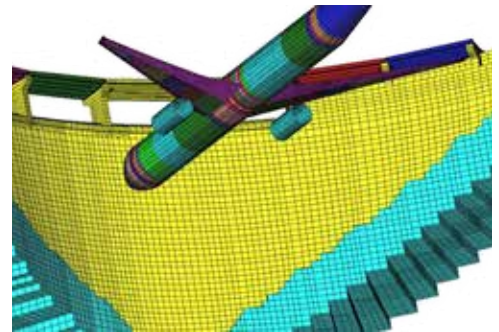

Impact Simulation

## QUALIFICATION AND CERTIFICATION

Structural Integrity's Qualification & Certification Division, TRU Compliance, is Capable of Handling Wind and Seismic Qualification of Structures, Systems and Components.

- Seismic Qualification of Structures, Systems and Components
  - Analytical
  - Testing – Shake Table
  - ICC-ES AC 156, IEEE 344 & 693
  - OSHPD OSP & OPA, CAN 2-1708A.5, IBC 1708.4
- Wind Qualification of Structures, Systems and Components



Air Handling Unit Awaiting Seismic Testing

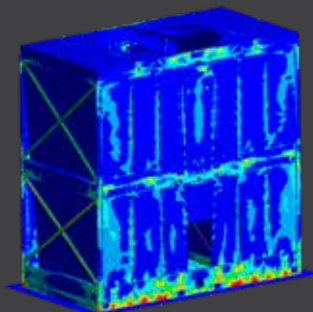

844.TRU.0200 | TRUCompliance.com